

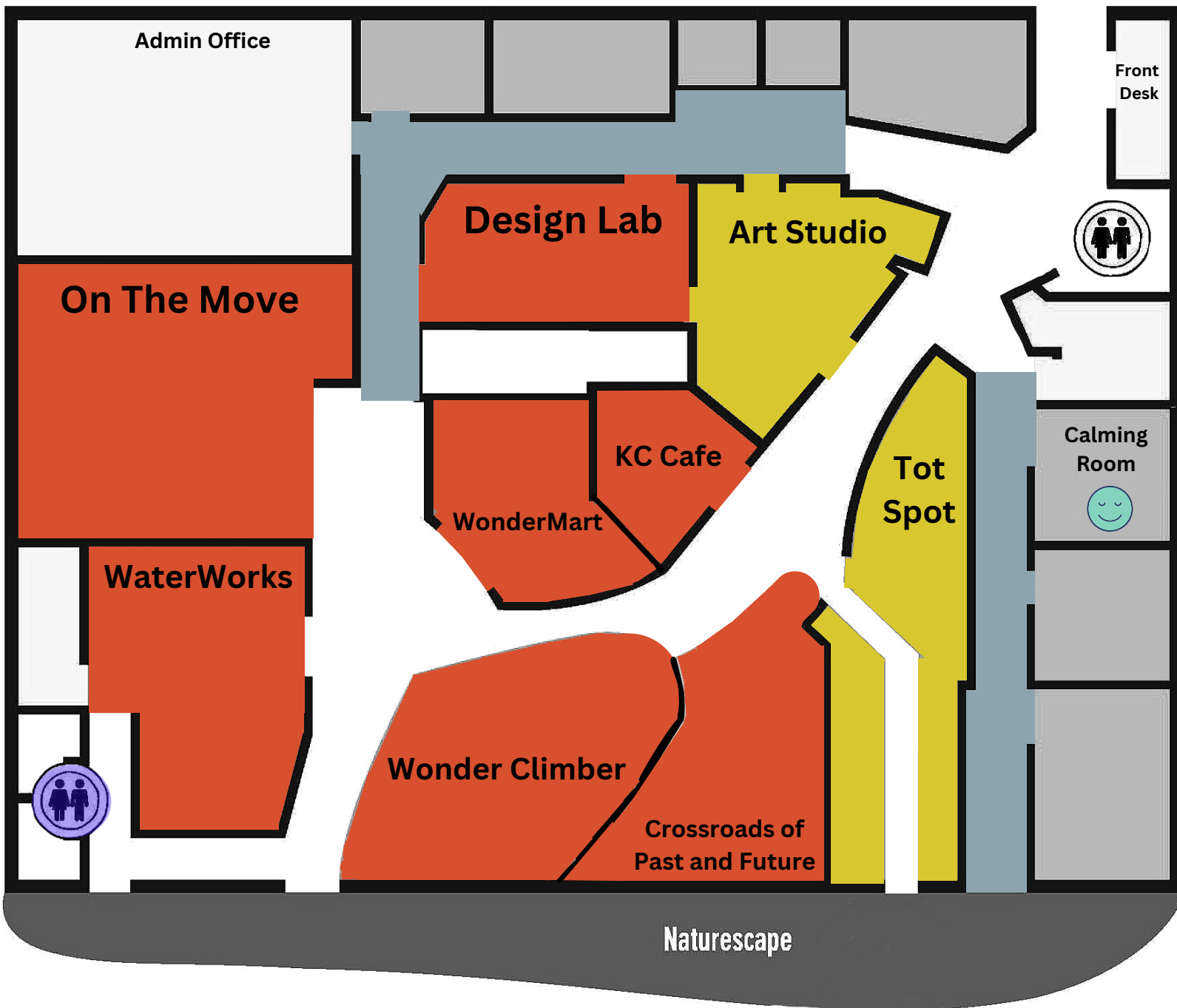





# Wonderscope Children's Museum

## Sensory Map



-  Low Sensory Area
-  Medium Sensory Area
-  High Sensory Area
-  Restroom with Adult Changing Table
-  Calming Room (only available on Sensory Mondays)

**High sensory areas (red)** are often more crowded, and may have a mix of sensory experiences

**Medium Sensory areas (green)** are often less crowded, and have lower noise levels.

**Low sensory areas (blue)** are usually the quietist and the least crowded. This is a good space to take a break.